



**22 Staveley Place, Ashton-On-Ribble, PR2 1UD**

**Asking price £185,000**

Welcome to this beautifully presented three-bedroom mid-terraced home, ideally situated on the popular Staveley Place in Ashton-On-Ribble, Preston. Renovated to a very, very high standard and tastefully decorated throughout, this stunning property offers modern living in a highly sought-after location, perfect for families, first-time buyers or anyone looking for a stylish, move-in ready home.

As you step inside, you're greeted by a small vestibule that provides access to the main reception room and stairs leading to the first floor. The spacious and inviting reception area is filled with natural light, creating a warm and welcoming atmosphere—ideal for relaxing or entertaining. From here, you'll find access to the modern kitchen, which has been thoughtfully designed and offers a seamless connection to the rear garden, perfect for enjoying sunny afternoons or outdoor dining.

Upstairs, the first floor features three well-proportioned bedrooms and a contemporary family bathroom, all finished to an exceptional standard with a keen eye for detail and quality throughout.





Floor Plan

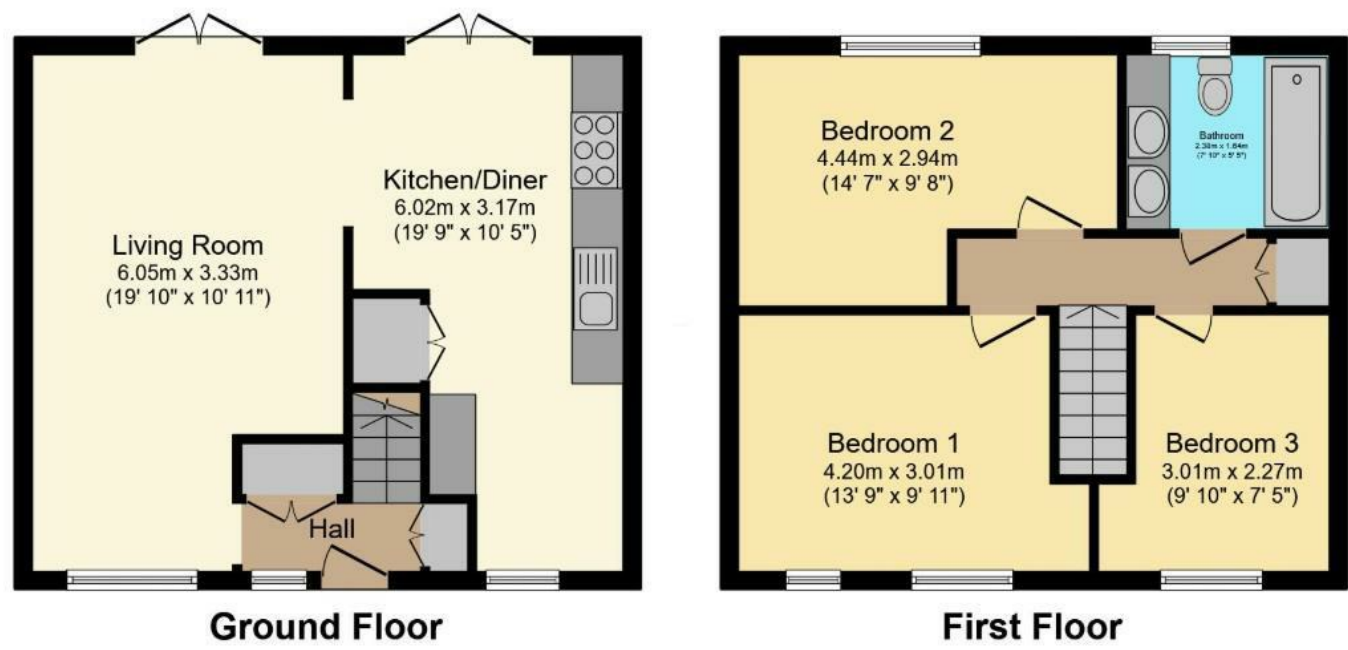

Area Map

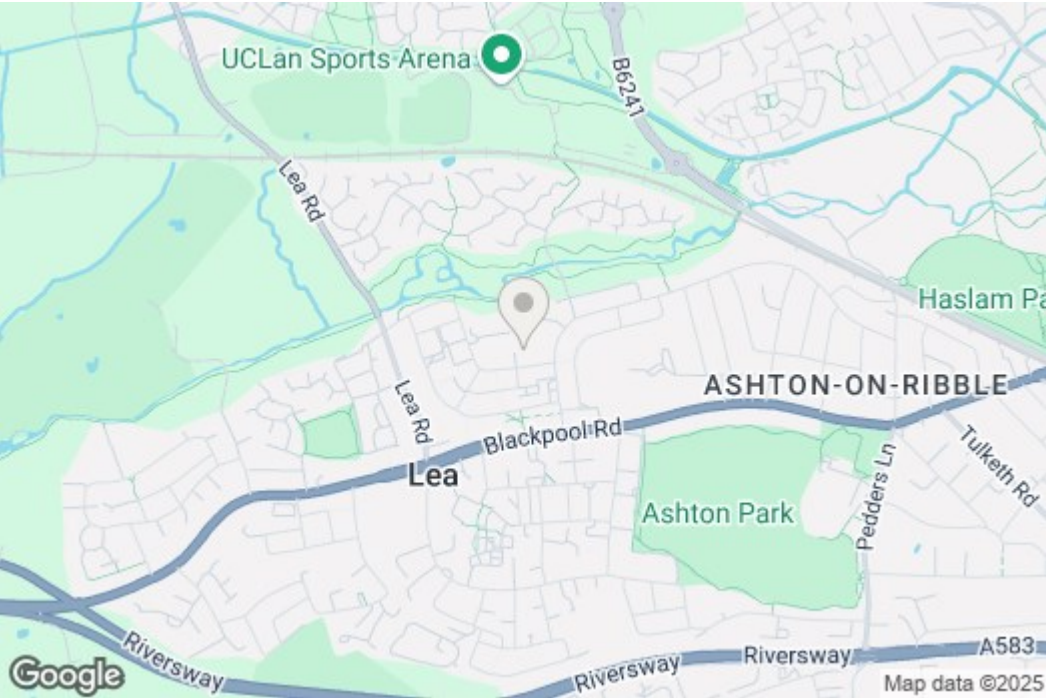

Energy Efficiency Graph

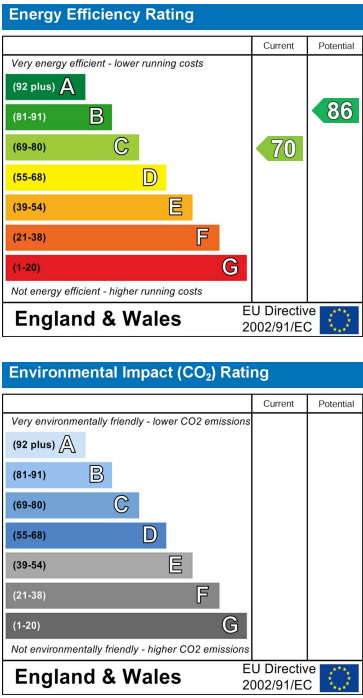

These particulars, whilst believed to be accurate are set out as a general outline only for guidance and do not constitute any part of an offer or contract. Intending purchasers should not rely on them as statements of representation of fact, but must satisfy themselves by inspection or otherwise as to their accuracy. No person in this firm's employment has the authority to make or give any representation or warranty in respect of the property.